

Central Article Code: C52030D03-A
 Local Code: EB16-B

Created: 22/11/2006
 Modified: 15/12/2020

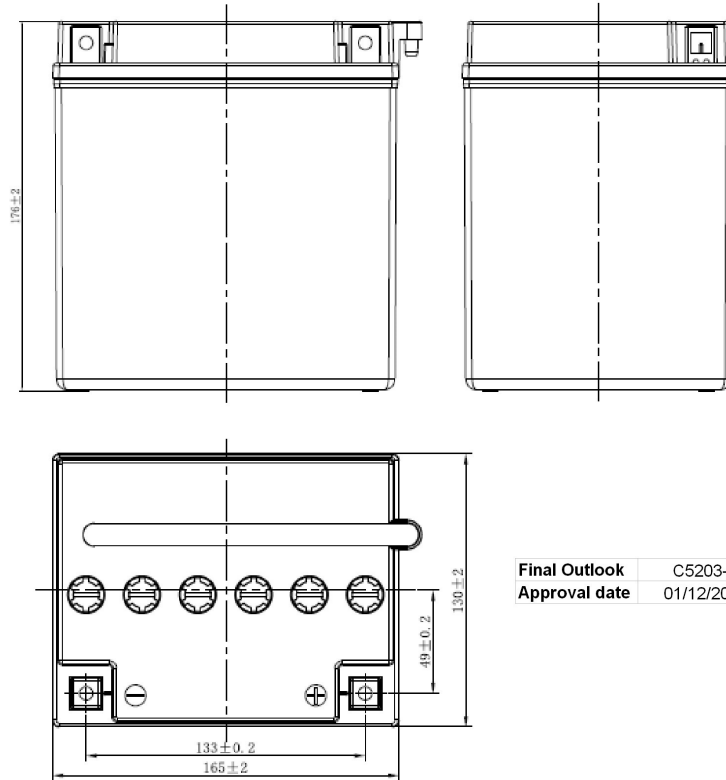

Final Outlook	C5203-A
Approval date	01/12/2009

PERFORMANCES		CONTAINER	
Voltage (V):	12 V	Type:	C52 WHITE
C20 (Ah):	30.0 10 h	Hold Down:	B0
Cranking (A):	300 EN	H.D. Adapter:	No
Charge:	DRY	COVER	
Technology:	Vented/Flooded	Type:	Motorbike (B ventilati BLACK
Grid:	Low Sb	Polarity:	ETN 0
Vibration:	Not Defined	Terminals:	M04
Endurance:	Not Defined	Terminal Adapter:	No
STD. DIMENSIONS		SOCI:	No
Length (mm ± 2):	165	Ventilation:	Moto-B
Width (mm ± 2):	130	Filter:	No
Height (mm ± 2):	175	Lateral Plug:	No
Total Weight (kg ± 5%):	8.80	PLUGS	
<p>This is a dry battery supplied with bottles of sulphuric acid. Sale of acid to end users is forbidden by Eu.Reg.1148/2019. Dry batteries must be filled with acid before delivery to end users</p> <p>All figures show nominal values. Tolerances are according to EN50342 and applicable European Regulations.</p>		Type:	6 x Moto Plug RED
		HANDLES	
		Type:	None
		OTHERS	
		Degassing Tube:	No
		EAC certified	